

PRODUCT DATA SHEET

Part Number	231
EAN	4015609000272
Manufacturer	Walther-Werke
WEEE-Reg-Nr:	DE 22131895

32A Plug 5P 400V 6hr IP44

- High impact thermoplastic housing featuring high resistance and toughness creating an abrasion-resistant material
- Retaining Device
- Internal Strain Relief with “swing-away” feature
- Locking Ring and Gasket
- Zinc Electroplated Steel Screws
- Shrouded Pins
- Color Coded by Voltage
- Walther can produce and supply the mating cable assemblies

NOTE: Also see 232 for a larger backshell to accommodate 5 wire 30A SOO cable sizes



Ordering/Logistics Information

Order Unit	Piece
Customs Number	85366990
Net Weight	0.52 lbs or 0.2377 kg
Packing Quantity (VPE)	10
Packaging Length	12.21 in or 0.31 m
Packaging Width	7.68 in or 0.195 m
Packaging Depth	5.51 in or 0.14 m
Gross Weight (VPE)	5.57 lbs or 2.525 kg

Conformities

CE Conformity	Y
RoHS directive	2011/65/EU
RoHS directive	2015/863/EU
REACH regulation	1907/2006

Certification

VDE/ENEC certification	40021520
UL certification	E329476
EAC certification	BY112.02.01.020 06090

Technical Product Data

IEC-amperage	32 A
Amperage according to UL/CSA (for UL-version)	30 A
Number of poles and wires	5 = 3P+N+G
Voltage according to EN 60309-2	400 V (50+60Hz)
Clock hour position	6 h
Identification color	Red
Conductor Cross Section	2.5 – 6 mm ²
Cable Diameter	0.39 in – 0.89 in or 10 mm - 22.5 mm
Cable Strip Length	1.77 in +/- 0.10 in or 45 mm +/- 2.5 mm
Cable Ferrules Length	0.39 in +/- 0.04 in or 10 mm +/- 1mm
Maximum torque terminal screw	0.8 Nm
Maximum torque cable gland	4 Nm
Degree of protection (IP)	IP44
Connection system	Screwed Terminal
Contact material	Nickel-Plated Brass
Cable entry	Swivel
Angle of plug	Straight
Material	Plastic
Inflammability class of insulation material according to UL94	V2

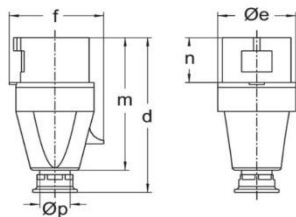

Amp.	16			32			63		
Pole	3	4	5	3	4	5	3	4	5
d	123	131	131	155	155	155	240	240	240
Øe	51	65	65	73	73	73	81	81	81
f	60	68	75	79	79	88	97	97	97
m	118	112	112	133	133	133	192	192	192
n	37	37	37	46	46	46	67	67	67
Øp	7.5-14.5	7.5-14.5	7.5-14.5	10-19.5	10-19.5	10-19.5	18-34.5	18-34.5	18-34.5

All specifications are subject to change without notice. Consult a Walthert Electric Engineer for the latest specifications or speak with a member of our Customer Care Team +1 (800) 925-8437.