

PRODUCT DATA SHEET

Part Number 430316

EAN

Manufacturer Walther-Werke

WEEE-Reg-Nr

30A 3P 125V 4H IP44 IEC Receptacle

- High Impact Thermoplastic featuring high resistance And toughness creating an abrasion-resistant material
- Gasket
- Zinc electroplated Steel Screws
- Double terminal screwed on all amperage devices
- Color Coded by voltage
- Ground first to mate – last to break for added safety
- Finger-safe in accordance with BGV A3 soft transition radius from flange to collar
- Walther can custom design configurations that meet your application requirements.
- Walther can produce and supply the mating cable assemblies.



Ordering/Logistics Information

Order Unit	Piece
Net Weight	0.44 lbs or 0.199 kg
Packing Quantity (VPE)	10
Packaging Length	12.21 in or 0.31 m
Packaging Width	7.68 in or 0.195 m
Packaging Depth	5.52 in or 0.14 m
Gross Weight (VPE)	4.72 lbs or 2.138 kg

Certification

VDE/ENEC certification	123021
UL certification	E83342 
EAC certification	BY112.02.01.020 060089
And multiple international certifications	

Classification system

Classification system	ETIM_6.0
ETIM Class	EC001317

Technical Product Data

IEC-amperage	32A
Amperage acc. UL/CSA	30A
Number of poles and wires	3= 1P + N + G
Voltage acc. EN 60309-2	125 V / (50-60HZ)
Clock hour position	4 h
Identification color	Yellow
RAL-number	1018
Degree of protection (IP)	IP44
Connection system	Screwed terminal
Angle of receptacle	Straight
Material	Plastic
Flange size vertical	2.95 in or 75 mm
Drill hole distance vertical	2.36 in or 60 mm
Flange size horizontal	2.95 in or 75 mm
Drill hole distance horizontal	2.36 in or 60 mm

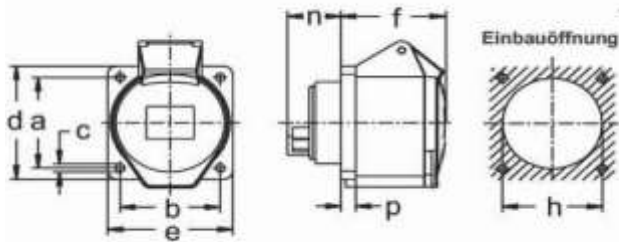

Amp.	16			32			Passender Blindflansch, Art.-Nr. 10 015:
	Pole	3	4	5	3	4	
a		60	60	60	60	60	60
b		60	60	60	60	60	60
c		5,5	5,5	5,5	5,5	5,5	5,5
d		75	75	75	75	75	75
e		75	75	75	75	75	75
f		52	53	53	65	65	65
h		46	60	60	60	60	60
n		28	28	28	27	27	27
p		6	9	9	9	9	9

All specifications are subject to change without notice. Consult a Walther Electric Engineer for the latest specifications or speak with a member of our Customer Care Team +1 (800) 925-8437.