

## PRODUCT DATA SHEET

Part Number	615
EAN	4015609000913
Manufacturer	Walther-Werke
WEEE-Reg-Nr	DE 22131895



### 20A 5P 400V 6H IP44 IEC Inlet

- High Impact Thermoplastic featuring high resistance and toughness creating an abrasion-resistant material
- Gasket
- Zinc electroplated Steel Screws
- Double terminal screwed on all amperage devices
- Color Coded by voltage
- Ground first to mate – last to break for added safety
- Finger-safe in accordance with BGV A3 soft transition radius from flange to collar
- Walther can custom design configurations that meet your application requirements.
- Walther can produce and supply the mating cable assemblies.

### Ordering/Logistics Information

Order Unit	Piece
Net Weight	0.33 lbs. or 0.149 kg
Packing Quantity (VPE)	10
Packaging Length	12.21 in or 0.31 m
Packaging Width	6.42 in or 0.163 m
Packaging Depth	4.45 in or 0.113 m
Gross Weight (VPE)	3.53 lbs. or 1.602 kg

### Certification

VDE/ENEC certification	125073
UL certification	E83342 
And multiple international certifications	

## Classification system

Classification system	ETIM_6.0
ETIM Class	EC001319

## Technical Product Data

IEC-amperage	16A
Amperage acc. UL/CSA	20A
Number of poles and wires	5 = 3P + N + G
Voltage acc. EN 60309-2	240-415 V / (50-60HZ)
Clock hour position	6 h
Identification color	Red
RAL-number	3000
Degree of protection (IP)	IP44
Connection system	Screwed terminal
Connection type	Built-up device plug
Angle of receptacle	Straight
Material	Plastic

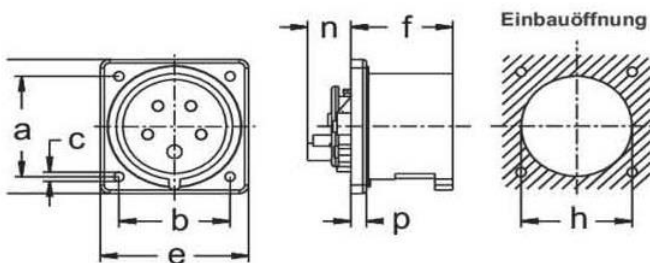

Amp.	16			32		
	3	4	5	3	4	5
Pole						
a	47	60	60	60	60	60
b	47	60	60	60	60	60
c	5,5	5,5	5,5	5,5	5,5	5,5
d	62	80	80	80	80	80
e	62	80	80	80	80	80
f	47	47	47	56	56	56
h	50	67	67	71	71	71
n	22	22	22	22	22	22
p	8,5	8,5	8,5	8,5	8,5	8,5

All specifications are subject to change without notice. Consult a Walther Electric Engineer for the latest specifications or speak with a member of our Customer Care Team +1 (800) 925-8437.